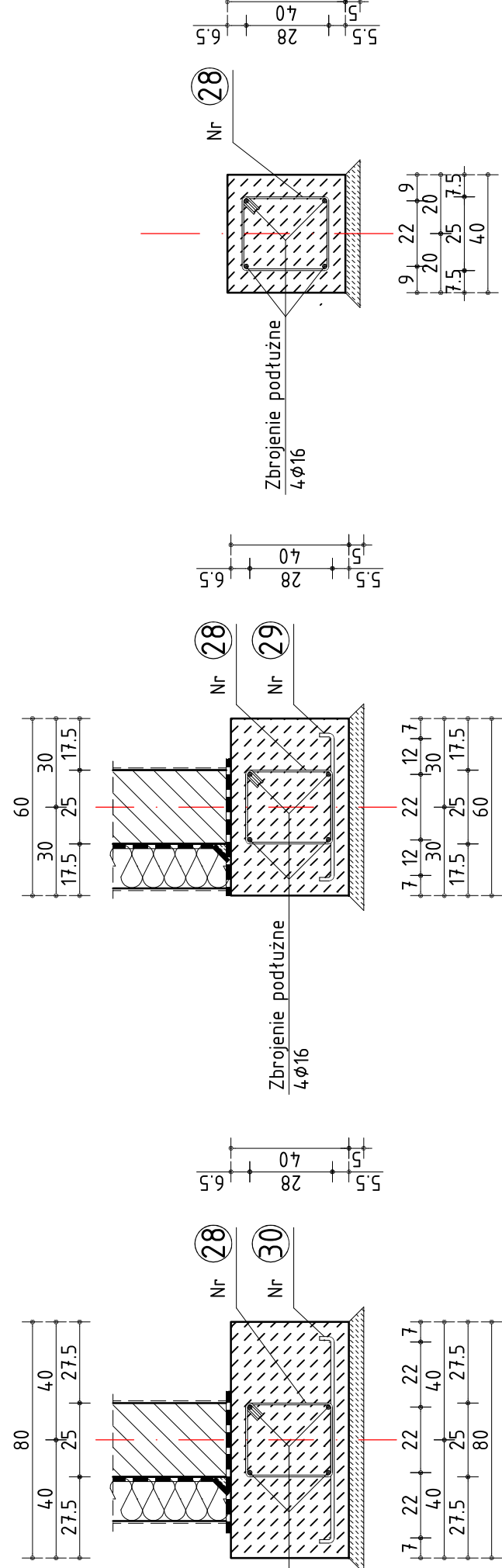

RZUT FUNDAMENTÓW

Nr. preta	Srednica [mm]	Dugopušć [mm]	Ilošć [sz/f]	Dugopušć carkovika [m]	
				6	12
17	16	2120	4	16	10,88
18	16	4860	2		9,72
19	16	4260	2		8,52
20	16	9050	4		28,20
21	16	5100	4		20,36
22	16	5370	2		40,36
23	16	4160	2		8,32
24	16	3920	2		15,84
25	16	3510	2		15,02
26	16	3310	8		58,48
27	16	5510	8		44,08
28	6	1170	318	372,06	
29	12	590	660		
30	12	930	960		
31	16	3630	104	39,94	
Masa jednog kosa [kg]				372,06	181,14
Masa jednog kosa [kg/ml]				0,222	0,868
Masa preta [kg]				82,60	160,85
004E-10 [kg]					988,93
					1232

[illegible]